

CONFERENCE ROOM LAYOUT

Style, please specify number:

1. **U-SHAPE (chairs only)**
Up to 22 people one row or up to 30 two rows



2. **U-SHAPE (with tables)**
Up to 16 people

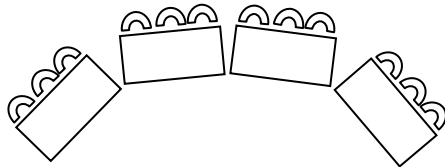

3. **FORMAL U-SHAPE**
Up to 14 people

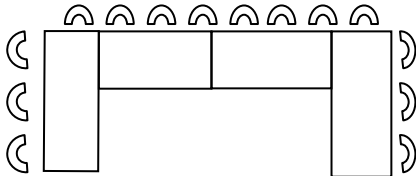

4. **BOARDROOM**
Up to 20 people

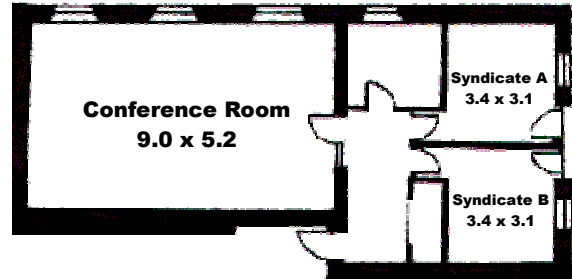
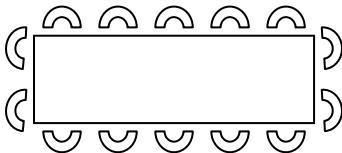

Northend's Conference Room

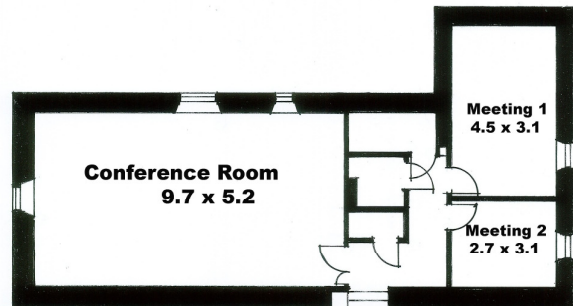

Bennett's Conference Room

Any other requirements, please specify

EQUIPMENT REQUIRED

Projector Screen

Data Projector

Flipcharts – 4 available

Magnetic Whiteboards

Magnotes in various colours & sizes 3", 4.5" & 6"

Syndicate Modellers including easels

Any other – please specify

Please return this form prior to your event